

Compiled Plan Covering
MIPL PIPELINE PROJECT

Twp's. 2 to 3
 Rge's. 28 to 29 W.1 M.
 Manitoba
 &
 Twp's. 2 & 3
 Rge. 30 W.1 M.
 Saskatchewan

SCALE - 1:40,000



LEGEND

- EOG Current Proposed Pipe: - - - - -
- EOG Current Previous Pipe: - - - - -
- EOG Pipes: - - - - -
- Other Pipes: - - - - -
- Paved Roads: - - - - -
- Improved Roads: - - - - -
- Unimproved Roads: - - - - -
- Truck Trails: - - - - -
- Urban Centre: [Yellow Box]
- Rivers/ Creeks: [Blue Wavy Line]
- Bodies of Water: [Blue Area]
- MHHC Area: [Blue Box]
- Species at Risk: [Orange Hatched Box]
- Soil Information Boundary: - - - - -
- Other Satellite Site: [ST Box]
- Other Battery Site: [BS Box]

WELL LEGEND

- Location
 - ⊕ Drilling
 - Gas Well
 - Oil Well
 - ⊕ Injection
 - ⊕ Gas Injection
 - ⊕ Service Well
 - ⊕ Ab'd Service Well
 - ⊕ Suspended
 - ⊕ Abandoned
 - ⊕ Abandoned Gas
 - ⊕ Suspended Gas
 - ⊕ Abandoned Oil
 - ⊕ Suspended Oil
 - ⊕ Heavy Oil
 - ⊕ Abandoned Heavy Oil
 - ⊕ Directional Drill
- All Other Symbols are in this color

BUFFER OFFSET

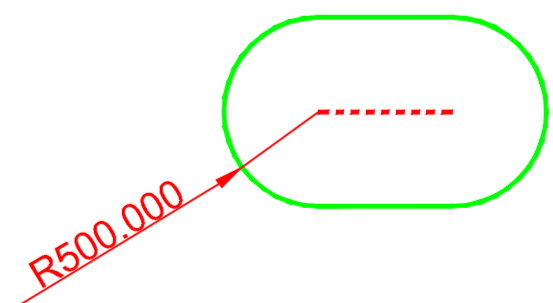

NO.	REVISION	BY	DATE
9.	Route Update	S.B.	December 18, 2012
8.	Original Route on Map Removed	S.B.	December 6, 2012
7.	Route Change	S.B.	November 21, 2012

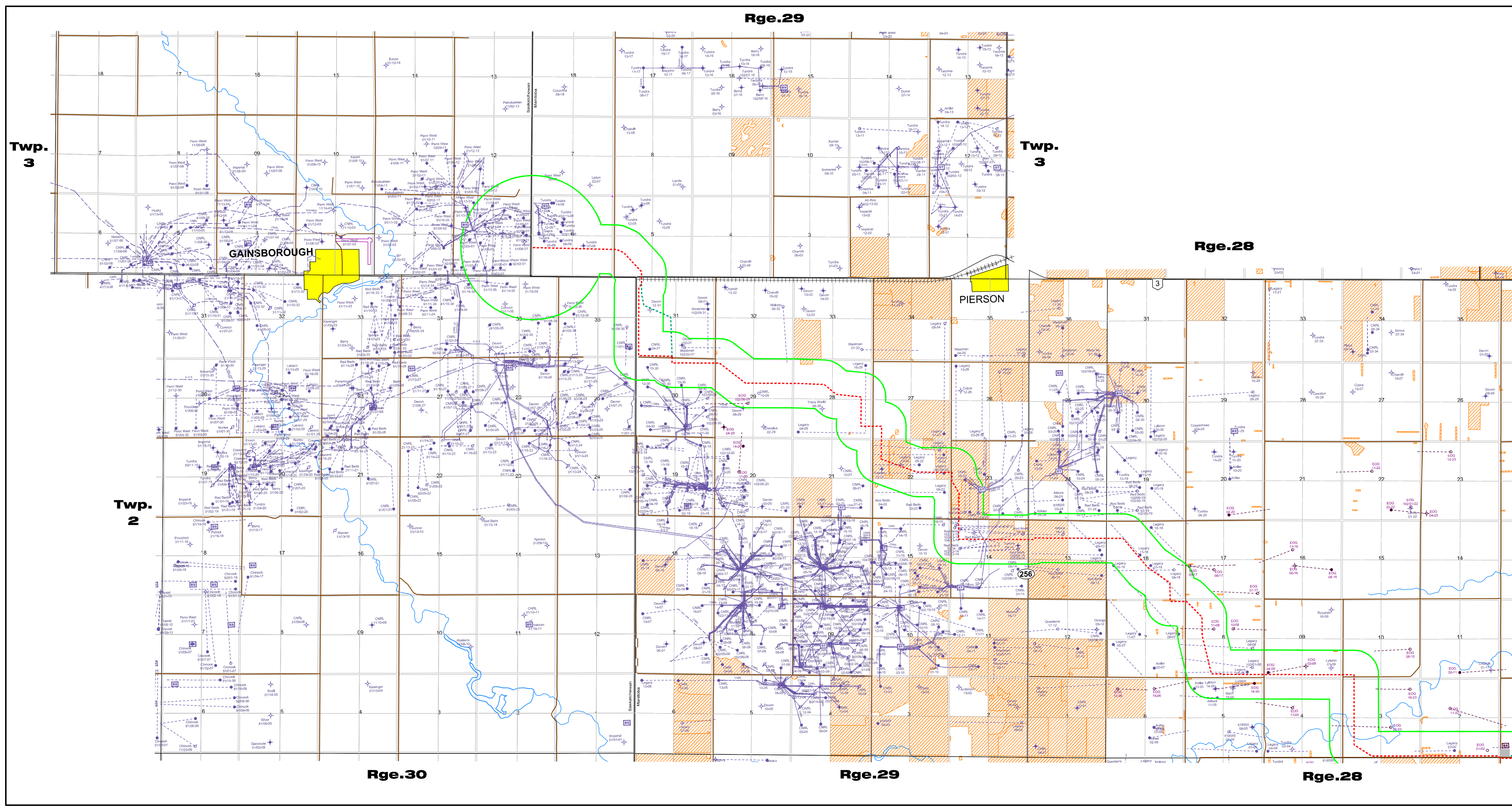

Twp. 3

Twp. 3

Rge. 28

PIERSON

GAINSBOROUGH

Twp. 2

Twp. 2

Rge. 30

Rge. 29

Rge. 28