

- ### LEGEND
- AGGREGATE DEPOSIT
 - ▲ GRAVEL PIT : Active, Private Sand and Gravel
 - △ GRAVEL PIT : Inactive and/or Depleted, Private Sand and Gravel
 - GRAVEL PIT : Active, Crown Sand and Gravel
 - GRAVEL PIT : Inactive and/or Depleted, Crown Sand and Gravel
 - BEDROCK QUARRY

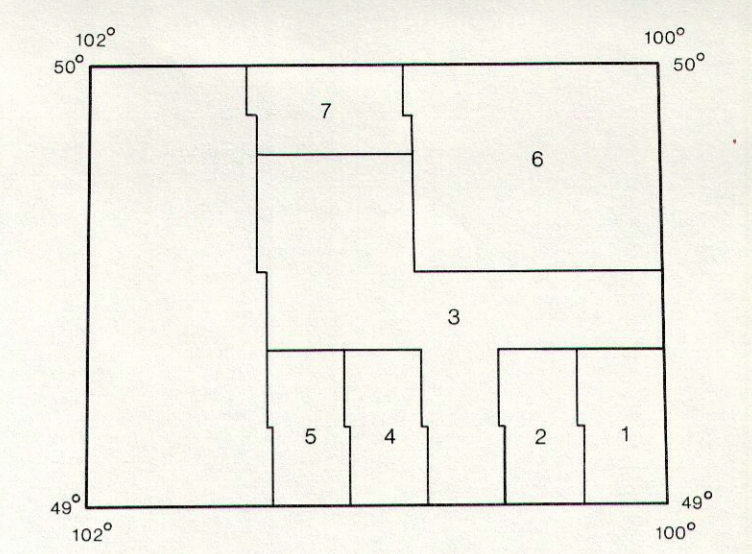

- ### SOURCES OF INFORMATION
- 1 Groom, H., 1987, Aggregate Deposits in the Rural Municipality of Merton, Manitoba Energy and Mines, Preliminary Map 1987 MOR, 1:50,000.
 - 2 Groom, H., 1987, Aggregate Deposits in the Rural Municipality of Winchester, Manitoba Energy and Mines, Preliminary Map 1987 WIN, 1:50,000.
 - 3 Elson, J. A., 1961, Surficial Geology Virden Manitoba and Saskatchewan, Geological Survey of Canada, Map 39-1961, 1:125,720.
 - 4 Groom, H., 1988, Aggregate Deposits in the Rural Municipality of Arthur, Manitoba Energy and Mines, Preliminary Map 1988 AR, 1:50,000.
 - 5 Groom, H., 1988, Aggregate Deposits in the Rural Municipality of Edward, Manitoba Energy and Mines, Preliminary Map 1988 ED, 1:50,000.
 - 6 Underwood McLellan and Associates Limited, 1977, Sand and Gravel Resources of the Brandon Region, Manitoba Energy and Mines, Open File Report OF77-8, 1:50,000.
 - 7 Berk, P. R., 1985, Aggregate Resources in the Rural Municipality of Wallace, Manitoba, Energy and Mines, Aggregate Report AR85-1, 1:50,000.
 - 8 Manitoba Mineral Resources Division, 1980, Quaternary Geology Map, Southern Manitoba 62F Virden, Geological Map AR80-6, 1:250,000.
 - 9 Manitoba Mineral Resources Division, 1980, Mineral Map of Manitoba, Map 80-1, 1:1,000,000.
 - 10 Manitoba Department of Highways and Transportation, Aggregate Resource Inventory, Block Files 1-3, 13-15 and 25-27.
 - 11 Manitoba Energy and Mines, Mining Recording Office, Quarry Mineral Disposition Files, Twps 1-12 and Rges 19-29W.

AGGREGATE RESOURCES COMPILATION MAP SERIES MAP AR88-1-4 VIRDEN NTS 62F

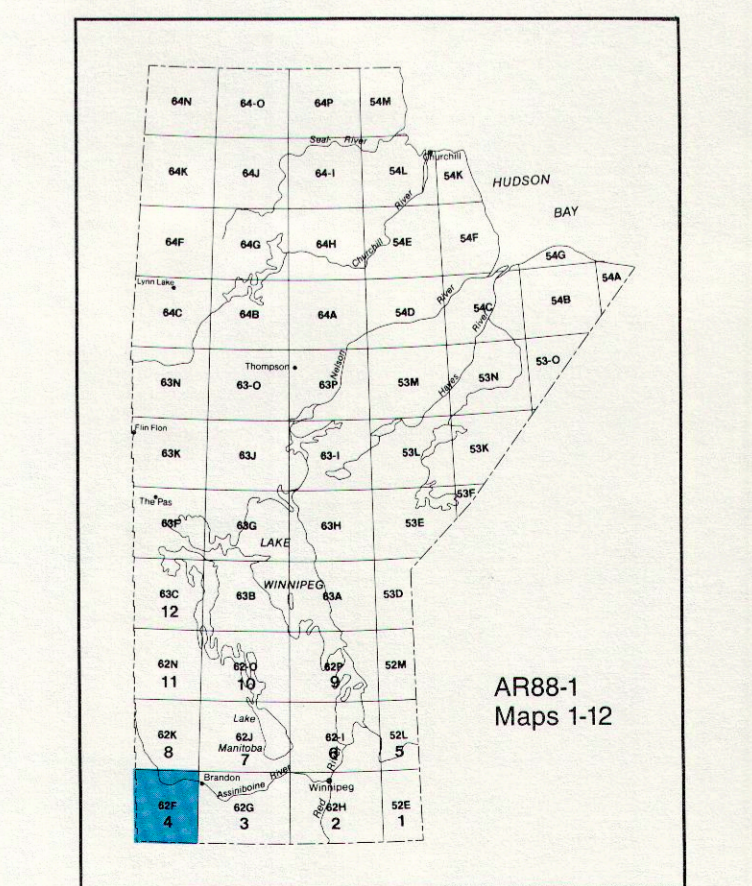

This map is a compilation of all known aggregate deposits, gravel pits and bedrock quarries in the area. The deposits include sand, sand and gravel and gravel. No distinction has been made based on the quality of the deposits. Where the aggregate deposit is small or a local feature, only the pit symbol has been shown. Where several pits are located within a small area, a single symbol has been used.

The information is based on aggregate reports, preliminary maps, surficial geology reports, Manitoba Department of Highways and Transportation aggregate resource inventories and Manitoba Energy and Mines quarry mineral disposition files. Mineral ownership data was compiled from the above data sources and Crown Lands Branch. No distinction has been made based on the mineral ownership of the bedrock quarries. This map is not to be regarded as final interpretation of the geology and mineral ownership of the area. References are included for users wishing to verify critical information.

Reasonable effort has been made to ensure the accuracy of the information presented on this map. However, Manitoba Energy and Mines and UMA Engineering Ltd. assume no liability for any errors that may occur. Additional information concerning the aggregate deposits, gravel pits or bedrock quarries may be obtained from: Manitoba Energy and Mines, Mining Engineering Section, 555-330 Graham Avenue, Winnipeg, Manitoba, Canada, R3C 4E3.

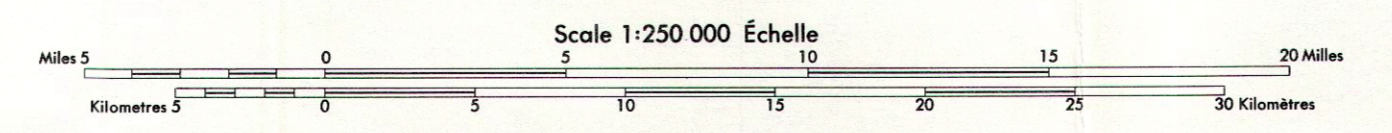

Compilation and Cartography by: UMA Engineering Limited.

Suggested reference to this publication:
Manitoba Energy and Mines, 1988; Aggregate Resources Compilation Map Series, Map AR88-1-4, Virden, NTS 62F, 1:250,000.

A contribution by Manitoba Energy and Mines, Mines Branch, to programming under the Canada-Manitoba Mineral Development Agreement (MDA), a subsidiary agreement of the Economic and Regional Development Agreement (ERDA).

Base map produced by the Surveys and Mapping Branch, 1977, Department of Energy, Mines and Resources.