

Waskada Unit No. 20

Waterflood Progress Report 2019

January 1st through December 31st 2019

Prepared for:

Manitoba Industry, Economic Development and Mines

Petroleum Branch

Prepared by:

Tundra Oil and Gas

March 19, 2020

INTRODUCTION

Waskada Unit No. 20 Enhanced Oil Recovery (EOR) Waterflood Project was approved February 1, 2017. Waskada Unit No. 20 area contains 23 vertical wells (14 abandoned / 9 producing) and 43 horizontal wells (5 abandoned/suspended and 38 producing) in 29 Legal Sub Divisions (LSD) in Township 1, Range 25 W1 as shown in the figure below.

This unit is currently not on injection.

Figure 1: Waskada Unit No. 20 Area Outline

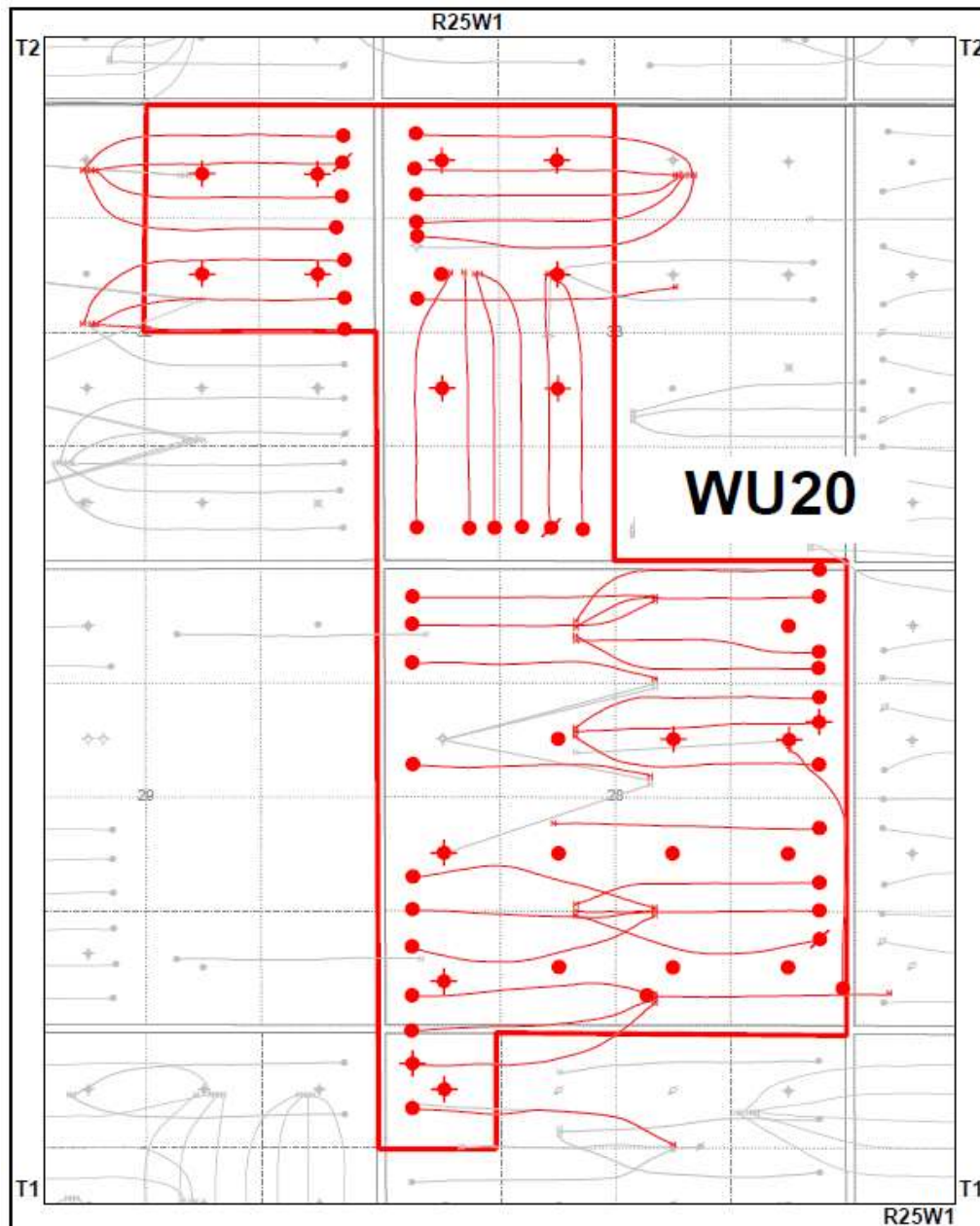

Waskada Unit No. 20

Tundra Oil and Gas (Tundra), as the operator of the Waskada Unit No. 20 Enhanced Oil Recovery (EOR) project hereby submits the 2019 EOR report as per section 73 of the Drilling and Production Regulations.

a) Monthly oil and water production rates, injection rate, GOR and WOR

| MONTH | Cal Dly Oil m ³ /day | Cal Dly Wtr m ³ /day | Cal Inj Wtr m ³ /day | WOR m ³ /m ³ | GOR m ³ /m ³ |
|----------|------------------------------------|------------------------------------|------------------------------------|---------------------------------------|---------------------------------------|
| Jan-2019 | 16.96 | 131.55 | 0.00 | 7.75 | 27.38 |
| Feb-2019 | 16.83 | 128.84 | 0.00 | 7.66 | 25.47 |
| Mar-2019 | 18.81 | 129.79 | 0.00 | 6.90 | 22.64 |
| Apr-2019 | 17.96 | 122.47 | 0.00 | 6.82 | 24.5 |
| May-2019 | 16.00 | 124.92 | 0.00 | 7.81 | 0 |
| Jun-2019 | 15.98 | 126.38 | 0.00 | 7.91 | 0 |
| Jul-2019 | 13.85 | 113.82 | 0.00 | 8.22 | 0 |
| Aug-2019 | 18.37 | 122.15 | 0.00 | 6.65 | 0 |
| Sep-2019 | 17.11 | 116.36 | 0.00 | 6.80 | 0 |
| Oct-2019 | 14.82 | 120.54 | 0.00 | 8.13 | 0 |
| Nov-2019 | 14.24 | 119.04 | 0.00 | 8.36 | 0 |
| Dec-2019 | 13.08 | 107.89 | 0.00 | 8.25 | 0 |

b) Cumulative volume of oil, gas and water produced and fluid injected

| 2019 PRODUCTION | |
|----------------------------------|-----------|
| Produced Oil (m ³) | 5,899 |
| Produced Gas (m ³) | 53 |
| Produced Water (m ³) | 44,506 |
| Fluid Injected (m ³) | 0 |
| CUMULATIVE PRODUCTION | |
| Produced Oil (m ³) | 384,011 |
| Produced Water (m ³) | 1,166,733 |

Waskada Unit No. 20

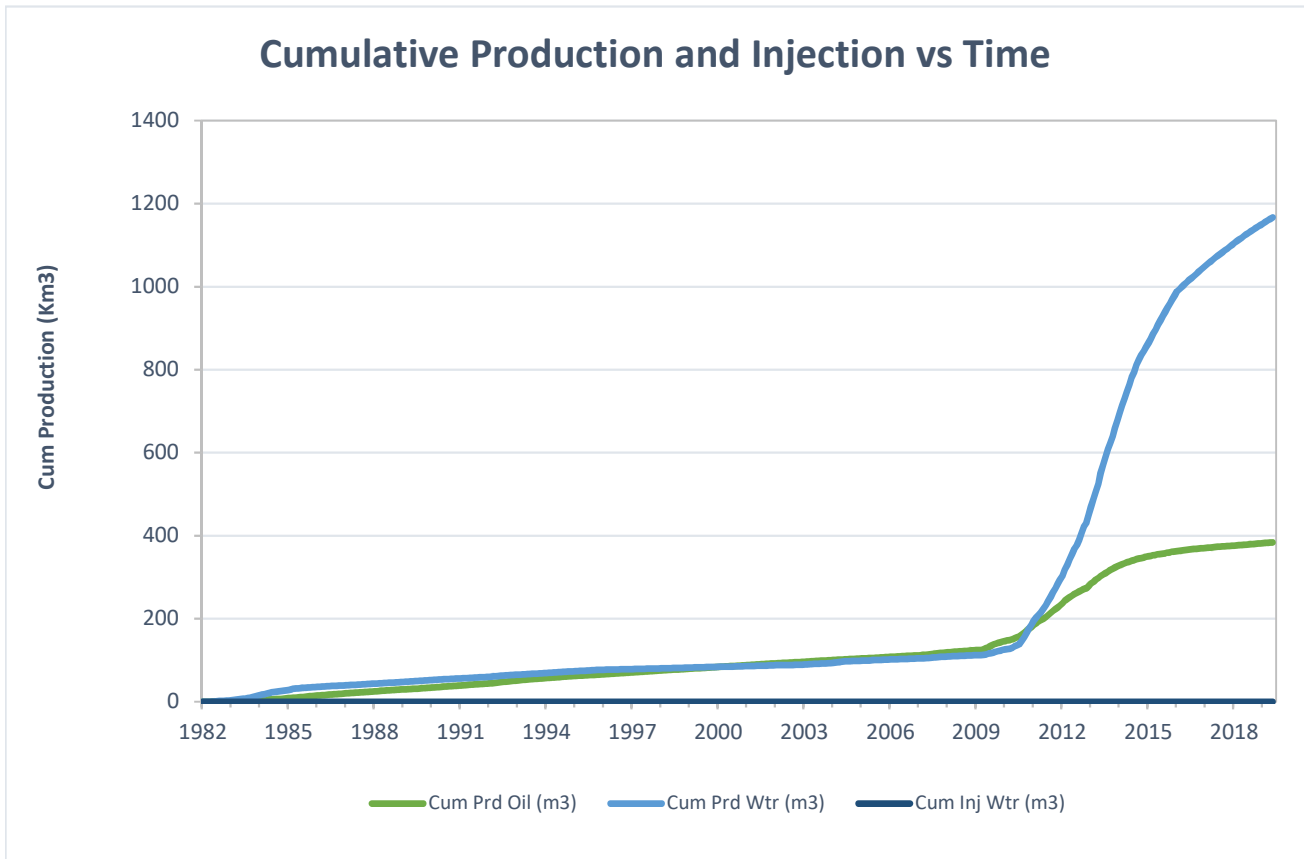

c) Well List

Waskada Unit No. 20 Well List

| <i>UWI</i> | <i>Type</i> | <i>Status</i> | <i>Future Plans</i> |
|----------------------|-------------|----------------|---------------------|
| 100/13-21-001-25W1/0 | Vertical | Abandoned | - |
| 103/13-21-001-25W1/0 | Horizontal | Abandoned Zone | - |
| 104/13-21-001-25W1/0 | Horizontal | Producing | - |
| 100/01-28-001-25W1/0 | Vertical | Pumping | - |
| 102/01-28-001-25W1/0 | Horizontal | Suspended | - |
| 103/01-28-001-25W1/0 | Horizontal | Producing | - |
| 100/02-28-001-25W1/0 | Vertical | Producing | - |
| 102/02-28-001-25W1/0 | Horizontal | Producing | - |
| 100/03-28-001-25W1/0 | Vertical | Pumping | - |
| 100/04-28-001-25W1/0 | Vertical | Abandoned | - |
| 102/04-28-001-25W1/0 | Horizontal | Producing | - |
| 103/04-28-001-25W1/0 | Horizontal | Producing | - |
| 100/05-28-001-25W1/0 | Vertical | Abandoned Zone | - |
| 102/05-28-001-25W1/0 | Horizontal | Producing | - |
| 103/05-28-001-25W1/0 | Horizontal | Producing | - |
| 100/06-28-001-25W1/0 | Vertical | Pumping | - |
| 100/07-28-001-25W1/0 | Vertical | Producing | - |
| 100/08-28-001-25W1/0 | Vertical | Producing | - |
| 102/08-28-001-25W1/0 | Horizontal | Producing | - |
| 103/08-28-001-25W1/0 | Horizontal | Producing | - |
| 104/08-28-001-25W1/0 | Horizontal | Producing | - |
| 100/09-28-001-25W1/0 | Vertical | Abandoned | - |
| 102/09-28-001-25W1/0 | Horizontal | Producing | - |
| 103/09-28-001-25W1/0 | Horizontal | Abandoned Zone | - |
| 104/09-28-001-25W1/0 | Horizontal | Producing | - |
| 100/10-28-001-25W1/0 | Vertical | Abandoned | - |
| 100/11-28-001-25W1/0 | Vertical | Pumping | - |
| 100/12-28-001-25W1/0 | Horizontal | Producing | - |
| 102/12-28-001-25W1/0 | Horizontal | N/A | - |
| 100/13-28-001-25W1/0 | Horizontal | Producing | - |
| 102/13-28-001-25W1/0 | Horizontal | Producing | - |
| 103/13-28-001-25W1/0 | Horizontal | Producing | - |
| 100/16-28-001-25W1/0 | Vertical | Abandoned Zone | - |
| 102/16-28-001-25W1/0 | Horizontal | Producing | - |
| 103/16-28-001-25W1/0 | Horizontal | Producing | - |
| 104/16-28-001-25W1/0 | Horizontal | Producing | - |
| 105/16-28-001-25W1/0 | Horizontal | Producing | - |
| 100/09-32-001-25W1/0 | Vertical | Abandoned Zone | - |
| 102/09-32-001-25W1/0 | Horizontal | Producing | - |
| 103/09-32-001-25W1/0 | Horizontal | Producing | - |
| 104/09-32-001-25W1/0 | Horizontal | Producing | - |
| 105/09-32-001-25W1/0 | Horizontal | Producing | - |
| 100/10-32-001-25W1/0 | Vertical | Abandoned | - |
| 100/15-32-001-25W1/0 | Vertical | Abandoned Zone | - |
| 100/16-32-001-25W1/0 | Vertical | Abandoned | - |

c) Well List

Waskada Unit No. 20 Well List

| <i>UWI</i> | <i>Type</i> | <i>Status</i> | <i>Future Plans</i> |
|----------------------|--------------------|----------------------|----------------------------|
| 102/16-32-001-25W1/0 | Horizontal | Producing | - |
| 103/16-32-001-25W1/0 | Horizontal | Suspended | - |
| 104/16-32-001-25W1/0 | Horizontal | Producing | - |
| 100/03-33-001-25W1/0 | Horizontal | Producing | - |
| 102/03-33-001-25W1/2 | Horizontal | Suspended | - |
| 103/03-33-001-25W1/0 | Horizontal | Producing | - |
| 100/04-33-001-25W1/0 | Horizontal | Producing | - |
| 102/04-33-001-25W1/0 | Horizontal | Producing | - |
| 103/04-33-001-25W1/0 | Horizontal | Producing | - |
| 100/05-33-001-25W1/0 | Vertical | Abandoned | - |
| 100/06-33-001-25W1/2 | Vertical | Abandoned | - |
| 100/11-33-001-25W1/0 | Vertical | Abandoned | - |
| 100/12-33-001-25W1/0 | Vertical | Producing | - |
| 102/12-33-001-25W1/2 | Horizontal | Producing | - |
| 103/12-33-001-25W1/0 | Horizontal | Producing | - |
| 104/12-33-001-25W1/0 | Horizontal | Producing | - |
| 100/13-33-001-25W1/0 | Vertical | Abandoned Zone | - |
| 102/13-33-001-25W1/0 | Horizontal | Producing | - |
| 103/13-33-001-25W1/0 | Horizontal | Producing | - |
| 104/13-33-001-25W1/0 | Horizontal | Producing | - |
| 102/14-33-001-25W1/0 | Vertical | Abandoned Zone | - |