

**WASKADA UNIT NO. 3
WATERFLOOD EOR PROJECT**

ANNUAL WATERFLOOD PROGRESS REPORT FOR 2015

April 30, 2016

Tundra Oil and Gas Partnership

Table of Contents

Introduction	3.
Discussion	4.
Production History	4.
Waterflood EOR Operating Strategy and Performance	5.
Water Source and Quality	5.
Injection Wellhead Pressures	5.
Reservoir Pressure	6.
Well Servicing	6.
Waterflood Performance Discussion	6.
List of Appendices	7.
Table 1: Waskada Unit No. 3 Well List and History	
Table 2: Waskada Unit No. 3 Voidage Replacement Ratio Calculation	
Table 3: Waskada Unit No. 3 Monthly Injection Table	
Table 4: Summary of Producing Well	

INTRODUCTION

Waskada Unit No. 3 Enhanced Oil Recovery (EOR) Waterflood Project was approved under Board Order No. PM58 effective May 1984. The Unit area contains 41 abandoned/suspended/inactive wells, including 14 inactive/abandoned injectors, and 70 producing wells in 50 LSDs in Townships 1 & 2, Ranges 25 & 26 W1 as shown in the figure below.

Figure 1: Waskada Unit 3 Area Outline

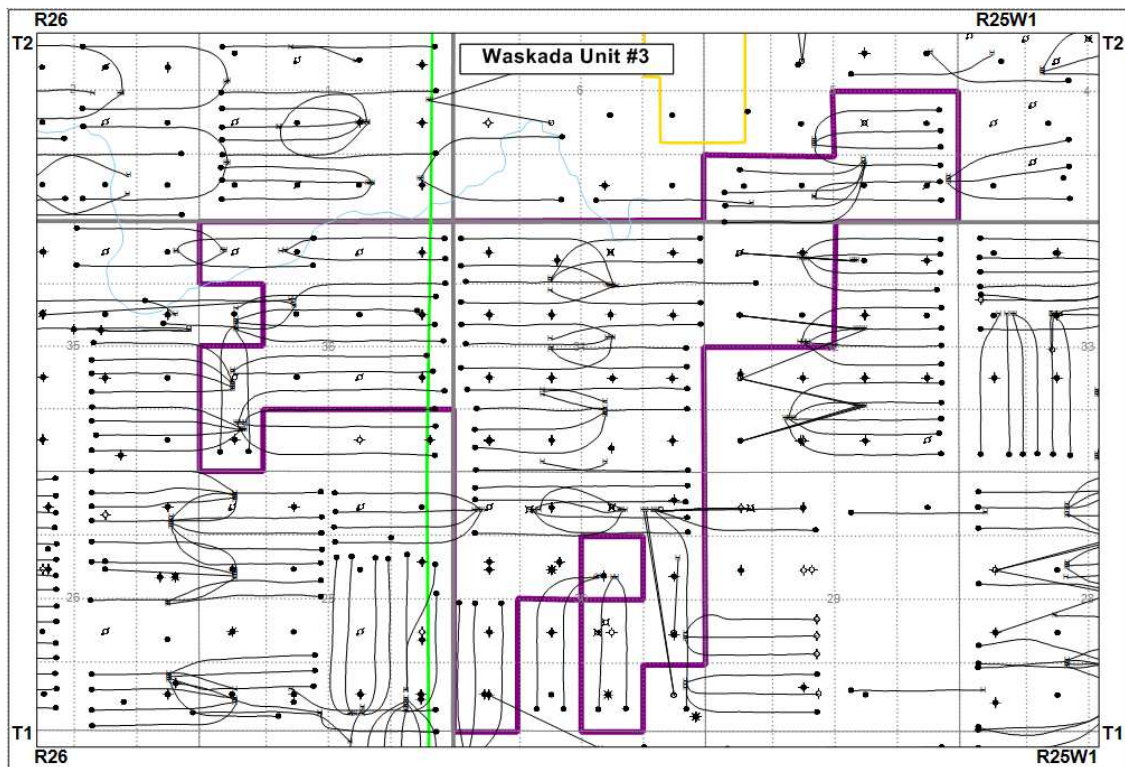

In accordance with Section 73 of the Manitoba Drilling and Production Regulation, Tundra hereby submits the following 2015 Annual Progress Report for Waskada Unit No. 3.

DISCUSSION

Production History

For the wells included in Waskada Unit No. 3, production started in June 1980 with the 00/11-30-001-25W1/2 Vertical well. Average oil production peaked for the first time at 2.2 m³/d per well in December 1984. This production was coming from 41 wells and totaled 92.7 m³/d for the whole Unit. The production at the end of December 2015 averaged 0.5 m³/d per well, totaling 22.3 m³/d for the Unit. Water was injected into Waskada Unit No. 3 from June 1984 until 2006. The rates and WOR are presented in Figure 2. There was no water injection through 2015, and there are no plans for injector re-activation.

Figure 2: Waskada Unit 3 Production/Injection Rates and WOR vs Time

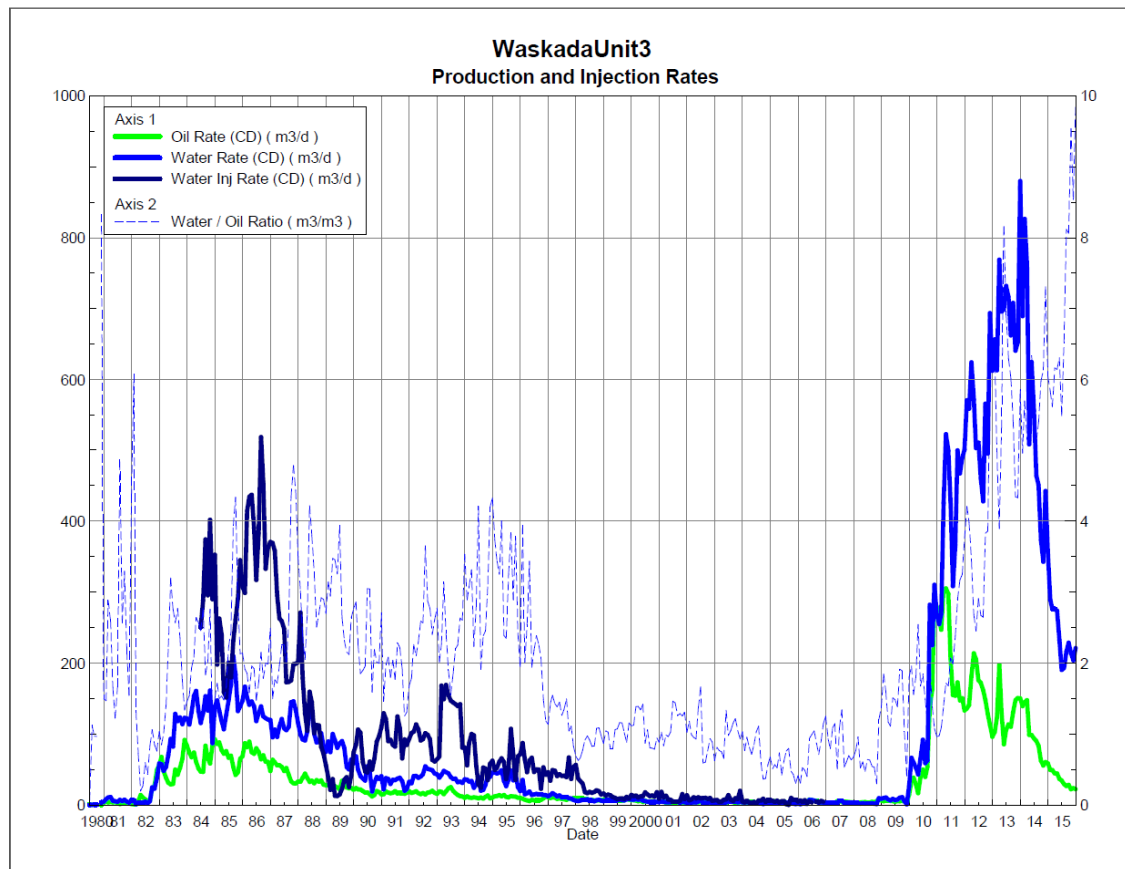
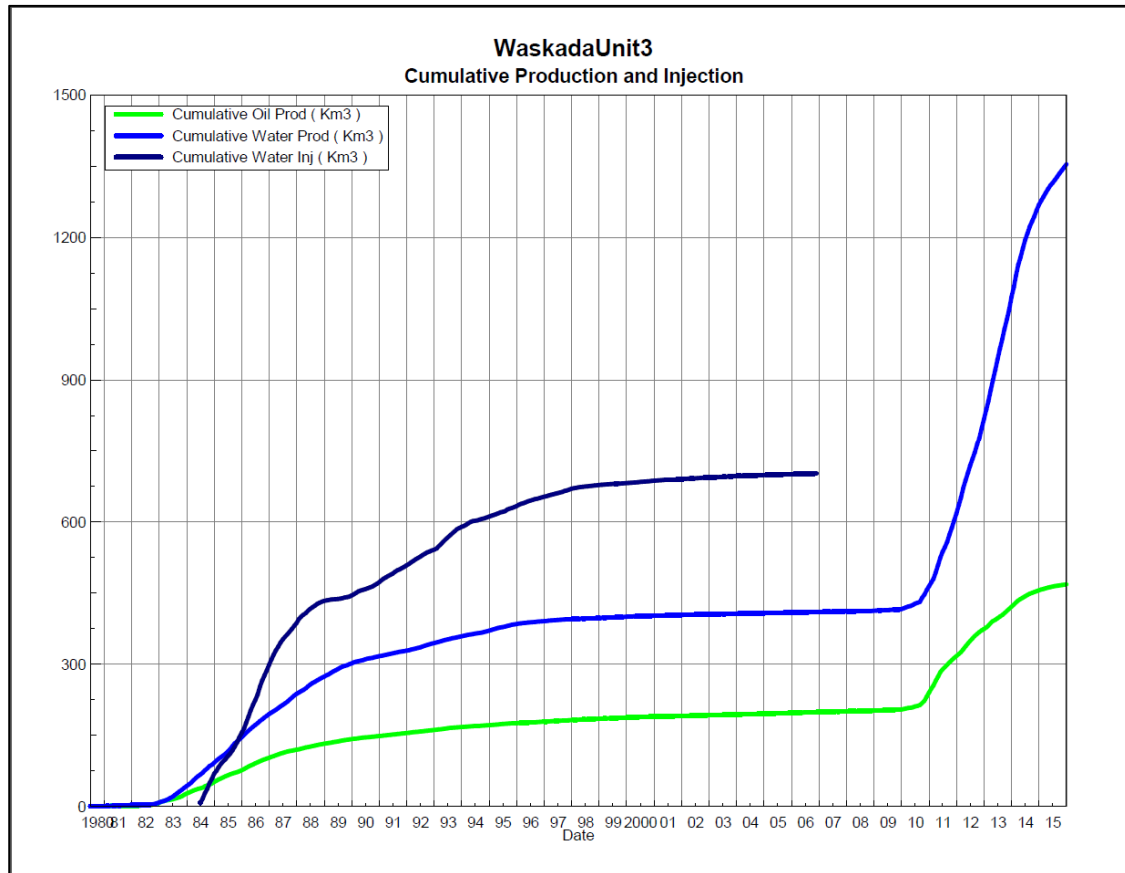

Figure 3 shows the cumulative production for Waskada Unit No. 3 to the end of December 2015 as 167.9 e³m³ of oil, and 1,354.0 e³m³ of water.

Figure 3: Waskada Unit 3 Cumulative Oil, Water and Water Injected vs Time



Waterflood EOR Operating Strategy and Performance

Corrosion and Scale Prevention

The facilities in Unit 3 are currently using cathodic and chemical protection against corrosion and scale in the new horizontal wells. All facilities are monitored every 3 months to assess the corrosion and ensure that proper electrical current is being supplied. There have been no issues with corrosion or scale to date.

Injection Wellhead Pressures

No injection wellhead pressures were recorded in 2015.

Reservoir Pressure

Where practical, Tundra is committed to collecting pressure data from newly drilled injection wells. Since no new wells were drilled in the Unit, therefore, no pressure surveys were conducted in 2015.

Well Servicing

No well servicing was performed in 2015 for Waskada Unit No. 3.

Waterflood Performance Discussion

From January 1 to December 31 in 2015, Waskada Unit No. 3 produced 97.9 e3m3 of fluid (12.5 e3m3 of Oil, 85.4 e3m3 of Water). There is no active injection in this Unit, and Tundra Oil and Gas has no plans to reactivate injection in the near future. Due to the new horizontals being produced and no pressure support occurring in the Unit, the cumulative VRR has dropped in the last 9 years, down to 0.371.

Table 2 summarizes the yearly and cumulative VRR for Waskada Unit No. 3.

Figure 4: Waskada Unit 3 Production and Injection Rate

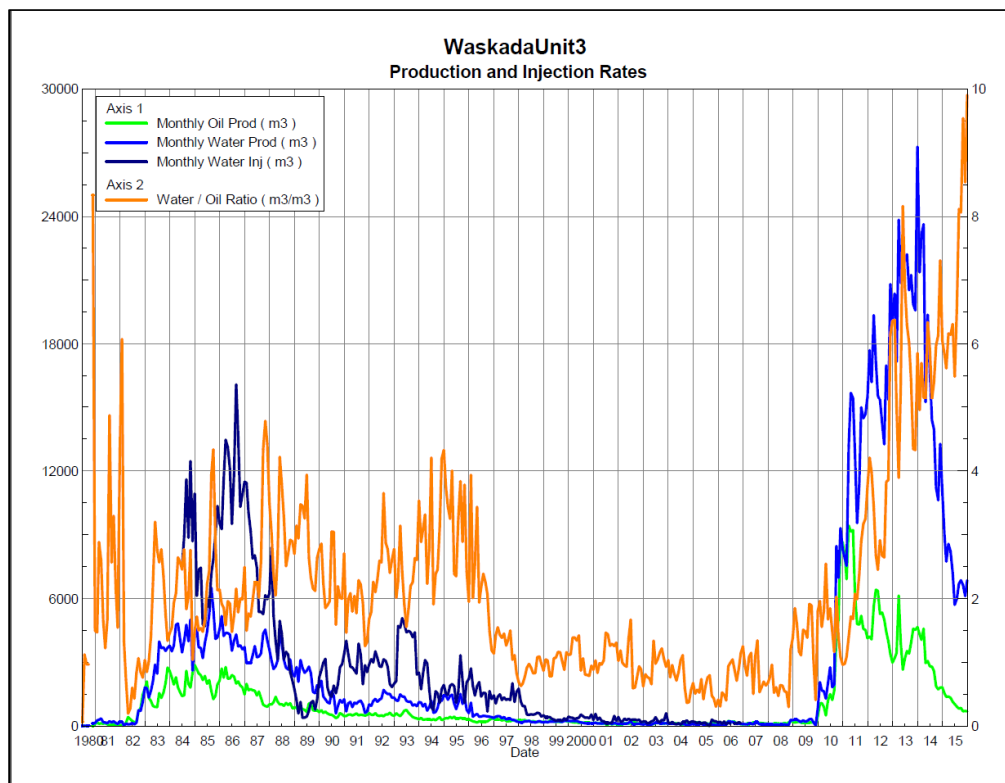

TABLE NO. 1: WASKADA UNIT NO. 3 WELL SUMMARY

UWI	Type	Status	On Prod Date	Cum Prd Oil (m3)	Cum Prd Water (m3)	Last Prod Date	Cum Inj Water (m3)	Last Inj Date
100/02-30-001-25W1/0	Vertical	Abandoned	10/1/1982	1324.2	2664.2	7/31/1989	0	
102/02-30-001-25W1/0	Horizontal	Producing	12/1/2011	5487.8	12860.5	12/1/2015	0	
103/02-30-001-25W1/0	Horizontal	Producing	1/1/2012	50.2	13617.3	12/31/2014	0	
102/04-30-001-25W1/0	Vertical	Abandoned	12/1/1982	6964.4	34069.5	6/30/1990	0	
100/05-30-001-25W1/2	Vertical	Abandoned	12/1/1980	570.4	1304.8	6/30/1984	97111.1	10/31/1998
102/05-30-001-25W1/0	Horizontal	Producing	9/1/2013	3588.7	6097.5	12/1/2015	0	
103/05-30-001-25W1/0	Horizontal	Producing	9/1/2013	2845.9	5637.2	12/1/2015	0	
104/05-30-001-25W1/0	Horizontal	Producing	9/1/2013	3815	2844.2	12/1/2015	0	
102/07-30-001-25W1/0	Vertical	Abandoned	12/1/1985	4182.2	2452.3	11/30/1987	20475.2	7/31/2003
100/08-30-001-25W1/2	Vertical	Abandoned	9/1/1983	4571	14854.7	6/30/1996	0	
100/09-30-001-25W1/0	Vertical	Abandoned Zone	3/1/1982	1144.4	1518	4/30/1989	0	
100/11-30-001-25W1/2	Vertical	Abandoned	6/1/1980	2181.8	5444.4	11/30/1984	0	
102/11-30-001-25W1/2	Vertical	Abandoned	11/1/1985	5783	37156.9	10/31/1997	0	
102/12-30-001-25W1/0	Vertical	Abandoned	12/1/1983	8747.2	10697.9	7/31/1994	0	
100/13-30-001-25W1/0	Vertical	Injection	8/1/1982	771.5	1351.5	5/31/1984	62196.9	10/31/2006
102/13-30-001-25W1/0	Horizontal	Producing	9/1/2013	598.9	3643.3	12/1/2015	0	
103/13-30-001-25W1/0	Horizontal	Producing	9/1/2013	1439.1	6940.1	12/1/2015	0	
104/13-30-001-25W1/0	Horizontal	Producing	9/1/2013	3767.4	9564.1	12/1/2015	0	
100/14-30-001-25W1/0	Vertical	Abandoned	9/1/1982	2876.9	6788.7	8/31/1990	0	
100/15-30-001-25W1/0	Vertical	Abandoned	9/1/1982	1773.3	7389.7	5/31/1984	86517.9	11/30/2006
100/16-30-001-25W1/0	Vertical	Abandoned	9/1/1982	3054.3	3615	12/31/1991	0	
102/16-30-001-25W1/0	Horizontal	Producing	10/1/2012	1779.9	31166.6	12/1/2015	0	
103/16-30-001-25W1/0	Horizontal	Producing	10/1/2012	767	44981.2	12/1/2015	0	
104/16-30-001-25W1/0	Horizontal	Producing	10/1/2012	2085.5	22529.5	12/1/2015	0	
105/16-30-001-25W1/0	Horizontal	Producing	11/1/2012	1532.2	20155.6	12/1/2015	0	
100/01-31-001-25W1/0	Vertical	Abandoned	7/1/1983	5057	33880.4	9/30/1990	0	
102/01-31-001-25W1/0	Horizontal	Producing	7/1/2010	3939.1	47404.3	6/30/2015	0	
100/02-31-001-25W1/0	Vertical	Abandoned	10/1/1982	3540	18477.5	10/31/1990	0	
100/03-31-001-25W1/0	Vertical	Abandoned	3/1/1982	2827.5	2333.9	8/31/1990	0	
102/04-31-001-25W1/0	Vertical	Abandoned	8/1/1982	1960.2	2800.5	10/31/1989	0	
103/04-31-001-25W1/0	Horizontal	Producing	12/1/2009	12062.7	10288.5	12/1/2015	0	
104/04-31-001-25W1/0	Horizontal	Producing	12/1/2009	2013	13923.4	12/1/2015	0	
105/04-31-001-25W1/0	Horizontal	Producing	3/1/2013	3658.1	5116.9	8/31/2015	0	
106/04-31-001-25W1/0	Horizontal	Producing	3/1/2013	1649.1	6278	1/31/2015	0	
100/05-31-001-25W1/0	Vertical	Abandoned	6/1/1983	778	321.2	5/31/1984	57646.5	2/28/1998
102/05-31-001-25W1/0	Horizontal	Producing	3/1/2013	2453.9	6056.4	11/30/2015	0	
103/05-31-001-25W1/0	Horizontal	Producing	3/1/2013	1812.3	4002.3	12/1/2015	0	
100/06-31-001-25W1/0	Vertical	Abandoned	9/1/1982	3196.6	13522	8/31/1990	0	
100/07-31-001-25W1/0	Vertical	Abandoned	7/1/1983	1360.5	1280.3	5/31/1984	59195.5	4/30/1992
100/08-31-001-25W1/0	Vertical	Abandoned	7/1/1983	5573.3	22602.9	7/31/1990	0	
102/08-31-001-25W1/0	Horizontal	Producing	8/1/2010	6011.4	38485.8	12/1/2015	0	
103/08-31-001-25W1/0	Horizontal	Producing	1/1/2013	1062.1	6993.1	12/1/2015	0	
104/08-31-001-25W1/0	Horizontal	Producing	1/1/2013	1154.7	11760.1	7/31/2015	0	
100/09-31-001-25W1/0	Vertical	Abandoned	9/1/1984	9678.6	29078.6	7/31/1990	0	
102/09-31-001-25W1/0	Horizontal	Producing	8/1/2010	5724.9	24506.9	4/30/2015	0.0	
103/09-31-001-25W1/0	Horizontal	Producing	2/1/2013	1648.4	6336.7	12/1/2015	0.0	
104/09-31-001-25W1/0	Horizontal	Producing	1/1/2013	1638.9	9063.0	12/1/2015	0.0	
100/10-31-001-25W1/0	Vertical	Abandoned	11/1/1984	565.9	1946.5	10/31/1990	0.0	
100/11-31-001-25W1/0	Vertical	Abandoned	12/1/1982	2393.3	4836.2	6/30/1990	0.0	
100/12-31-001-25W1/2	Vertical	Abandoned	7/1/1984	4256.0	16750.5	9/30/1991	0.0	
102/12-31-001-25W1/0	Horizontal	Producing	9/1/2010	7375.2	23852.4	12/1/2015	0.0	
103/12-31-001-25W1/0	Horizontal	Producing	8/1/2013	216.0	3018.9	6/30/2015	0.0	
104/12-31-001-25W1/0	Horizontal	Producing	3/1/2013	800.7	2284.4	12/1/2015	0.0	
100/13-31-001-25W1/0	Vertical	Abandoned	3/1/1983	513.0	572.0	8/31/1985	41892.5	2/28/1998
102/13-31-001-25W1/0	Horizontal	Producing	10/1/2010	2393.8	14040.1	12/1/2015	0.0	
103/13-31-001-25W1/0	Horizontal	Producing	8/1/2013	1212.3	2026.8	12/1/2015	0.0	
104/13-31-001-25W1/0	Horizontal	Producing	8/1/2013	755.8	2250.8	7/31/2015	0.0	
100/14-31-001-25W1/0	Vertical	Abandoned	9/1/1983	827.3	3049.6	5/31/1990	0.0	
100/15-31-001-25W1/0	Vertical	Abandoned	11/1/1984	1028.4	1661.5	9/30/1985	20126.3	2/28/1998
100/16-31-001-25W1/0	Vertical	Abandoned	10/1/1984	1739.6	2802.2	5/31/1989	0.0	
102/16-31-001-25W1/0	Horizontal	Producing	9/1/2010	4759.4	16235.7	4/30/2014	0.0	
103/16-31-001-25W1/0	Horizontal	Producing	2/1/2013	2558.4	8240.9	12/1/2015	0.0	
104/16-31-001-25W1/0	Horizontal	Producing	2/1/2013	1437.4	9169.7	12/1/2015	0.0	
100/11-32-001-25W1/0	Vertical	Producing	9/1/1984	7782.3	21560.8	6/30/2013	0.0	
100/12-32-001-25W1/0	Vertical	Producing	11/1/1984	5623.9	2942.8	6/30/2013	0.0	
100/13-32-001-25W1/0	Vertical	Injection	11/1/1984	695.1	697.4	9/30/1985	60098.7	4/30/1999
102/13-32-001-25W1/0	Horizontal	Producing	2/1/2012	8679.4	41926.1	12/1/2015	0.0	
100/14-32-001-25W1/0	Vertical	Abandoned	10/1/1982	4594.8	13367.4	9/30/1997	0.0	
103/01-27-001-26W1/0	Horizontal	Producing	9/1/2010	6451.5	25475.0	12/1/2015	0.0	
104/01-36-001-26W1/0	Horizontal	Producing	10/1/2012	3685.7	5467.7	12/1/2015	0.0	
100/04-36-001-26W1/0	Vertical	Abandoned	2/1/1986	2429.8	697.6	2/29/1996	0.0	
102/04-36-001-26W1/0	Horizontal	Producing	9/1/2010	9595.2	4180.3	11/30/2014	0.0	
103/04-36-001-26W1/0	Horizontal	Producing	3/1/2011	7407.5	3072.3	9/30/2014	0.0	
100/05-36-001-26W1/0	Vertical	Injection	10/1/1983	3814.4	520.6	11/30/1986	22659.9	6/30/2005

100/06-36-001-26W1/0	Vertical	Producing	7/1/1985	5583.3	1470.1	7/31/2013	0.0	
100/07-36-001-26W1/0	Vertical	Injection	12/1/1985	839.3	137.4	10/31/1986	51991.8	5/31/2004
100/08-36-001-26W1/0	Vertical	Abandoned	7/1/1984	4915.4	17331.8	3/31/2003	0.0	
102/08-36-001-26W1/0	Horizontal	Producing	7/1/2010	8378.4	9927.9	12/1/2015	0.0	
103/08-36-001-26W1/0	Horizontal	Producing	3/1/2011	1386.1	5774.0	8/31/2015	0.0	
104/08-36-001-26W1/0	Horizontal	Producing	3/1/2011	1028.5	5125.4	12/1/2015	0.0	
100/09-36-001-26W1/2	Vertical	Abandoned	2/1/1984	6635.9	31124.0	11/30/1995	0.0	
102/09-36-001-26W1/0	Horizontal	Producing	9/1/2010	9297.0	6845.9	12/1/2015	0.0	
103/09-36-001-26W1/0	Horizontal	Producing	3/1/2011	2796.7	4550.9	12/1/2015	0.0	
104/09-36-001-26W1/0	Horizontal	Producing	3/1/2011	3089.4	9250.6	12/1/2015	0.0	
105/09-36-001-26W1/0	Horizontal	Producing	3/1/2011	3455.0	3930.8	2/28/2014	0.0	
100/10-36-001-26W1/0	Vertical	Producing	7/1/1984	6738.8	1141.5	3/31/2011	0.0	
100/11-36-001-26W1/0	Vertical	Producing	9/1/1983	7082.9	1420.6	11/30/2013	0.0	
100/13-36-001-26W1/0	Vertical	Injection	10/1/1983	2604.7	445.0	9/30/1985	33783.4	11/30/2005
100/14-36-001-26W1/0	Vertical	Producing	11/1/1983	6251.5	1198.9	3/31/2012	0.0	
102/14-36-001-26W1/0	Horizontal	Producing	11/1/2010	10570.4	3453.3	12/31/2014	0.0	
103/14-36-001-26W1/0	Horizontal	Producing	10/1/2010	7082.5	3481.0	12/1/2015	0.0	
100/15-36-001-26W1/0	Vertical	Injection	7/1/1984	1272.1	355.8	9/30/1985	51994.3	1/31/2006
100/16-36-001-26W1/0	Vertical	Abandoned	8/1/1985	613.3	511.2	1/31/1989	0.0	
102/16-36-001-26W1/0	Horizontal	Producing	5/1/2010	5741.5	12108.1	6/30/2013	0.0	
103/16-36-001-26W1/0	Horizontal	Producing	11/1/2010	9693.5	4213.2	2/28/2015	0.0	
104/16-36-001-26W1/0	Horizontal	Producing	2/1/2013	3029.8	1613.2	12/1/2015	0.0	
100/01-05-002-25W1/0	Vertical	Suspended	1/1/1985	7128.2	14931.8	10/31/2009	0.0	
102/01-05-002-25W1/0	Horizontal	Producing	2/1/2011	289.3	13412.6	6/30/2012	0.0	
103/01-05-002-25W1/0	Horizontal	Producing	2/1/2011	12628.2	69653.1	10/31/2015	0.0	
104/01-05-002-25W1/0	Horizontal	Producing	2/1/2011	8212.4	44969.2	12/1/2015	0.0	
100/02-05-002-25W1/0	Vertical	Producing	1/1/1985	9137.3	1696.2	9/30/2011	0.0	
100/03-05-002-25W1/0	Vertical	Producing	11/1/1982	5966.0	2217.3	1/31/2012	0.0	
100/04-05-002-25W1/0	Vertical	Producing	10/1/1985	7484.8	13819.8	1/31/2012	0.0	
102/04-05-002-25W1/0	Horizontal	Producing	2/1/2012	5671.8	7631.4	12/1/2015	0.0	
103/04-05-002-25W1/0	Horizontal	Producing	2/1/2012	7759.5	41510.8	12/1/2015	0.0	
104/04-05-002-25W1/0	Horizontal	Producing	2/1/2012	6435.5	30184.2	12/1/2015	0.0	
100/07-05-002-25W1/0	Vertical	Abandoned	12/1/1984	1193.6	1193.1	7/31/1986	35948.8	3/31/1994
100/08-05-002-25W1/0	Vertical	Producing	12/1/1984	19194.4	3480.2	12/1/2015	0.0	
102/08-05-002-25W1/0	Horizontal	Producing	2/1/2011	6337.5	44124.8	1/31/2015	0.0	
103/08-05-002-25W1/0	Horizontal	Producing	2/1/2011	7472.5	39482.4	12/1/2015	0.0	
104/08-05-002-25W1/0	Horizontal	Producing	2/1/2011	10809.1	43864.1	12/1/2015	0.0	
				467900.7	1354085.2	701638.8		

TABLE NO. 2 - VRR Calculations

Date	Mth Oil Prod m3	Cum Oil Prod Km3	Mth Water Prod m3	Cum Water Prod Km3	Water Oil Ratio m3/m3	Mth Water Inj m3	Cum Water Inj Km3	VRR	Cum VRR
12/31/1980	183	183.200	315	314.800	1.72		0.000	0.000	0.000
12/31/1981	1124	1306.800	2500	2814.800	2.22		0.000	0.000	0.000
12/31/1982	6379	7685.400	5322	8137.000	0.83		0.000	0.000	0.000
12/31/1983	19167	26852.000	34598	42735.400	1.81		0.000	0.000	0.000
12/31/1984	24582	51434.200	49131	91866.400	2.00	68953	68952.700	0.891	0.457
12/31/1985	24638	76072.300	53585	145451.600	2.17	85890	154842.800	1.048	0.665
12/31/1986	26265	102337.700	49175	194626.500	1.87	143288	298131.200	1.805	0.955
12/31/1987	17020	119358.100	42395	237021.900	2.49	88310	386441.300	1.425	1.032
12/31/1988	12535	131892.700	36320	273341.900	2.90	46449	432890.200	0.916	1.019
12/31/1989	9713	141605.500	28005	301346.400	2.88	11519	444409.100	0.294	0.957
12/31/1990	6630	148235.800	15180	316526.600	2.29	27898	472306.600	1.223	0.970
12/31/1991	6384	154619.600	11631	328157.800	1.82	35537	507843.100	1.873	1.004
12/31/1992	6335	160954.600	16071	344228.700	2.54	33244	541087.300	1.423	1.022
12/31/1993	6308	167262.300	14199	358427.800	2.25	48126	589213.700	2.243	1.070
12/31/1994	3922	171183.800	11965	370393.100	3.05	21512	610725.900	1.306	1.077
12/31/1995	4424	175608.100	13839	384232.100	3.13	22294	633020.100	1.178	1.080
12/31/1996	2925	178533.200	6174	390406.100	2.11	19503	652522.800	2.045	1.095
12/31/1997	3315	181848.500	4165	394570.800	1.26	16774	669296.400	2.103	1.109
12/31/1998	2782	184630.700	2406	396976.400	0.86	7958	677253.900	1.420	1.112
12/31/1999	2628	187258.700	2651	399627.800	1.01	4079	681332.800	0.719	1.108
12/31/2000	1996	189254.800	2140	401767.800	1.07	4886	686219.200	1.102	1.108
12/31/2001	1400	190655.100	1589	403356.300	1.13	3538	689756.700	1.106	1.108
12/31/2002	1511	192166.300	1419	404775.100	0.94	3284	693041.100	1.040	1.108
12/31/2003	1476	193642.400	1445	406220.300	0.98	3172	696212.700	1.009	1.107
12/31/2004	1620	195262.200	1145	407365.000	0.71	1967	698179.400	0.654	1.105
12/31/2005	1717	196979.100	921	408286.200	0.54	1944	700123.800	0.671	1.103
12/31/2006	1788	198766.600	1442	409728.000	0.81	1515	701638.800	0.433	1.099
12/31/2007	1541	200307.300	1268	410995.800	0.82		701638.800	0.000	1.094
12/31/2008	1636	201942.900	1245	412240.900	0.76		701638.800	0.000	1.089
12/31/2009	2290	204233.100	3461	415701.700	1.51		701638.800	0.000	1.078
12/31/2010	35612	239845.400	48282	463983.900	1.36		701638.800	0.000	0.948
12/31/2011	76913	316758.500	153099	617082.800	1.99		701638.800	0.000	0.715
12/31/2012	57099	373857.900	201016	818098.900	3.52		701638.800	0.000	0.562
12/31/2013	47130	420988.000	256619	1074718.000	5.44		701638.800	0.000	0.450
12/31/2014	34408	455396.300	193887	1268604.500	5.63		701638.800	0.000	0.391
12/31/2015	12504	467900.700	85481	1354085.200	6.84		701638.800	0.000	0.371

TABLE NO. 3

**Tundra Oil and Gas
Waskada Unit No. 3
2015 Injection Volumes**

Well Location	Date	Hours On	H ₂ O Inj Cal-d avg (m ³ /d)	Monthly Injected H ₂ O (m ³)
Unit No. 3 Total:				
	Jan-15	0	0.0	0.00
	Feb-15	0	0.0	0.00
	Mar-15	0	0.0	0.00
	Apr-15	0	0.0	0.00
	May-15	0	0.0	0.00
	Jun-15	0	0.0	0.00
	Jul-15	0	0.0	0.00
	Aug-15	0	0.0	0.00
	Sep-15	0	0.0	0.00
	Oct-15	0	0.0	0.00
	Nov-15	0	0.0	0.00
	Dec-15	0	0.0	0.00
2015 Group Totals:				0.00

Unit No. 3 Total:

1980	0	0	0.00
1981	0	0	0.00
1982	0	0	0.00
1983	0	0	0.00
1984	0	321.6	9,850.39
1985	0	235.6	7,157.51
1986	0	392.75	11,940.70
1987	0	242.66	7,359.18
1988	0	126.99	3,870.74
1989	0	31.43	959.91
1990	0	76.57	2,324.79
1991	0	97.38	2,961.38
1992	0	90.9	2,770.35
1993	0	132.2	4,010.53
1994	0	59.2	1,792.68
1995	0	61.0	1,857.85
1996	0	53.2	1,625.22
1997	0	46.0	1,397.80
1998	0	21.9	663.13
1999	0	11.2	339.91
2000	0	13.4	407.20
2001	0	9.7	294.79
2002	0	9.0	273.70
2003	0	8.7	264.30
2004	0	5.4	163.89
2005	0	5.3	162.03
2006	0	5.0	151.50
2007	0	0.0	0.00
2008	0	0.0	0.00
2009	0	0.0	0.00
2010	0	0.0	0.00
2011	0	0.0	0.00
2012	0	0.0	0.00
2013	0	0.0	0.00
2014	0	0.0	0.00
2015	0	0.0	0.00
Group Totals:			62,599.48

TABLE NO. 4

**Tundra Oil and Gas
Waskada Unit No. 3
2015 Production Volumes**

Date	Hours On	Oil Rate (CD) m3/d	Monthly Oil Prod m3	Water Rate (CD) m3/d	Monthly Water Prod m3	Water Oil Ratio m3/m3	Well Count
Jan-15	33,914	49.49	1,534	289	8,960	6	46
Feb-15	29,518	49.14	1,376	276	7,735	6	44
Mar-15	35,225	44.78	1,388	276	8,559	6	47
Apr-15	33,367	44.49	1,335	273	8,204	6	46
May-15	34,737	36.76	1,140	232	7,192	6	47
Jun-15	31,108	34.59	1,038	190	5,701	5	43
Jul-15	30,456	29.54	916	193	5,985	7	41
Aug-15	27,888	26.61	825	216	6,694	8	37
Sep-15	26,952	28.34	850	229	6,856	8	37
Oct-15	28,584	22.41	695	214	6,626	10	38
Nov-15	28,032	23.89	717	204	6,117	9	39
Dec-15	28,296	22.32	692	221	6,852	10	38
	368,077		12,504		85,481		

Date	Hours On	Oil Rate (CD) m3/d	Monthly Oil Prod m3	Water Rate (CD) m3/d	Monthly Water Prod m3	Water Oil Ratio m3/m3	Well Count
31/12/1980	4320	1.00	31	1.72	52	2.16	1
31/12/1981	17088	3.08	94	6.87	208	2.52	2
31/12/1982	45384	17.41	532	14.51	444	1.18	5
31/12/1983	160512	52.46	1,597	94.47	2883	1.98	18
31/12/1984	228384	67.14	2,049	134.11	4094	2.09	26
31/12/1985	287352	67.61	2,053	146.67	4465	2.33	33
31/12/1986	310050	72.03	2,189	134.78	4098	1.90	35
31/12/1987	272109	46.69	1,418	116.16	3533	2.76	31
31/12/1988	250992	34.26	1,045	99.22	3027	2.93	29
31/12/1989	221592	26.58	809	76.68	2334	2.90	25
31/12/1990	178752	18.19	553	41.64	1265	2.28	20
31/12/1991	152520	17.51	532	31.90	969	1.82	17
31/12/1992	151368	17.31	528	43.89	1339	2.56	17
31/12/1993	144720	17.30	526	38.92	1183	2.36	17
31/12/1994	136728	10.74	327	32.79	997	3.07	16
31/12/1995	134232	12.12	369	37.93	1153	3.11	15
31/12/1996	103152	7.99	244	16.85	515	2.21	12
31/12/1997	104880	9.10	276	11.44	347	1.25	12
31/12/1998	90312	7.63	232	6.59	200	0.88	10
31/12/1999	82272	7.20	219	7.26	221	1.02	9
31/12/2000	66744	5.46	166	5.86	178	1.07	8
31/12/2001	57096	3.84	117	4.35	132	1.16	7
31/12/2002	61368	4.14	126	3.89	118	0.96	7
31/12/2003	64224	4.05	123	3.96	120	0.98	7
31/12/2004	72720	4.42	135	3.13	95	0.74	8
31/12/2005	65304	4.71	143	2.53	77	0.55	8
31/12/2006	72703	4.89	149	3.93	120	0.80	8
31/12/2007	76,496	4.22	128	3.47	106	0.84	9
31/12/2008	74,375	4.46	136	3.40	104	0.71	9
31/12/2009	75,816	6.26	191	9.46	288	1.43	9
31/12/2010	112,692	97.37	2,968	132.23	4024	1.62	13
31/12/2011	224,110	210.99	6,409	418.94	12758	2.20	26
31/12/2012	270,493	156.00	4,758	549.67	16751	3.76	31
31/12/2013	399,501	129.08	3,928	702.28	21385	5.66	46
31/12/2014	431,500	94.51	2,867	532.92	16157	5.77	49
31/12/2015	368,077	34.36	1,042	234.42	7123	7.19	42
	5,569,938		39,007		112,867		