

Waskada Unit No. 7

Waterflood Progress Report 2019

January 1st through December 31st 2019

Prepared for:

Manitoba Industry, Economic Development and Mines

Petroleum Branch

Prepared by:

Tundra Oil and Gas

March 18, 2020

INTRODUCTION

Waskada Unit No. 7 Enhanced Oil Recovery (EOR) Waterflood Project was approved under Board Order No. PM 58 effective January 1987. The Unit area contains 24 abandoned/suspended wells, including 5 abandoned injectors, and 15 producing/inactive wells in 19 LSDs in Township 1 Range 25 W1 as shown in the figure below.

This unit is currently not on injection and there are no plans for injector re-activation.

Figure 1: Waskada Unit No. 7 Area Outline

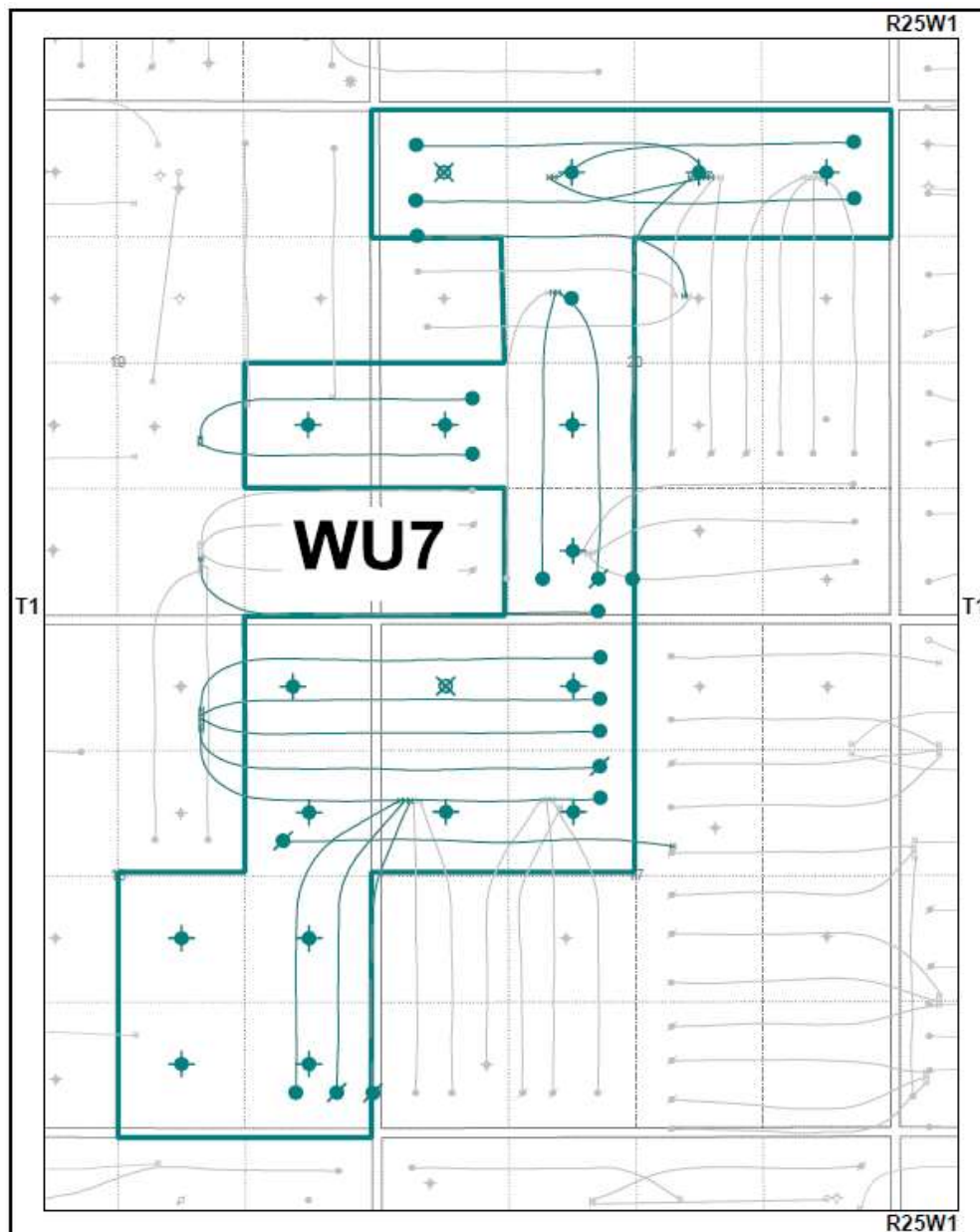

Waskada Unit No. 7

Tundra Oil and Gas (Tundra), as the operator of the Waskada Unit No. 7 Enhanced Oil Recovery (EOR) project hereby submits the 2019 EOR report as per section 73 of the Drilling and Production Regulations.

a) Monthly oil and water production rates, injection rate, GOR and WOR

MONTH	Cal Dly Oil m ³ /day	Cal Dly Wtr m ³ /day	Cal Inj Wtr m ³ /day	WOR m ³ /m ³	GOR m ³ /m ³
Jan-2019	3.40	83.85	0.00	24.69	0
Feb-2019	3.01	84.07	0.00	27.92	0
Mar-2019	3.22	78.98	0.00	24.51	0
Apr-2019	3.70	73.17	0.00	19.76	0
May-2019	4.54	70.61	0.00	15.56	0
Jun-2019	3.47	66.08	0.00	19.06	0
Jul-2019	2.65	66.47	0.00	25.13	0
Aug-2019	3.08	64.92	0.00	21.07	0
Sep-2019	3.68	62.23	0.00	16.90	0
Oct-2019	2.54	58.88	0.00	23.19	0
Nov-2019	2.38	54.67	0.00	23.00	0
Dec-2019	2.77	50.45	0.00	18.19	0

b) Cumulative volume of oil, gas and water produced and fluid injected

2019 PRODUCTION	
Produced Oil (m ³)	1,169
Produced Gas (m ³)	0
Produced Water (m ³)	24,738
Fluid Injected (m ³)	0
CUMULATIVE PRODUCTION	
Produced Oil (m ³)	165,777
Produced Water (m ³)	966,656

Waskada Unit No. 7

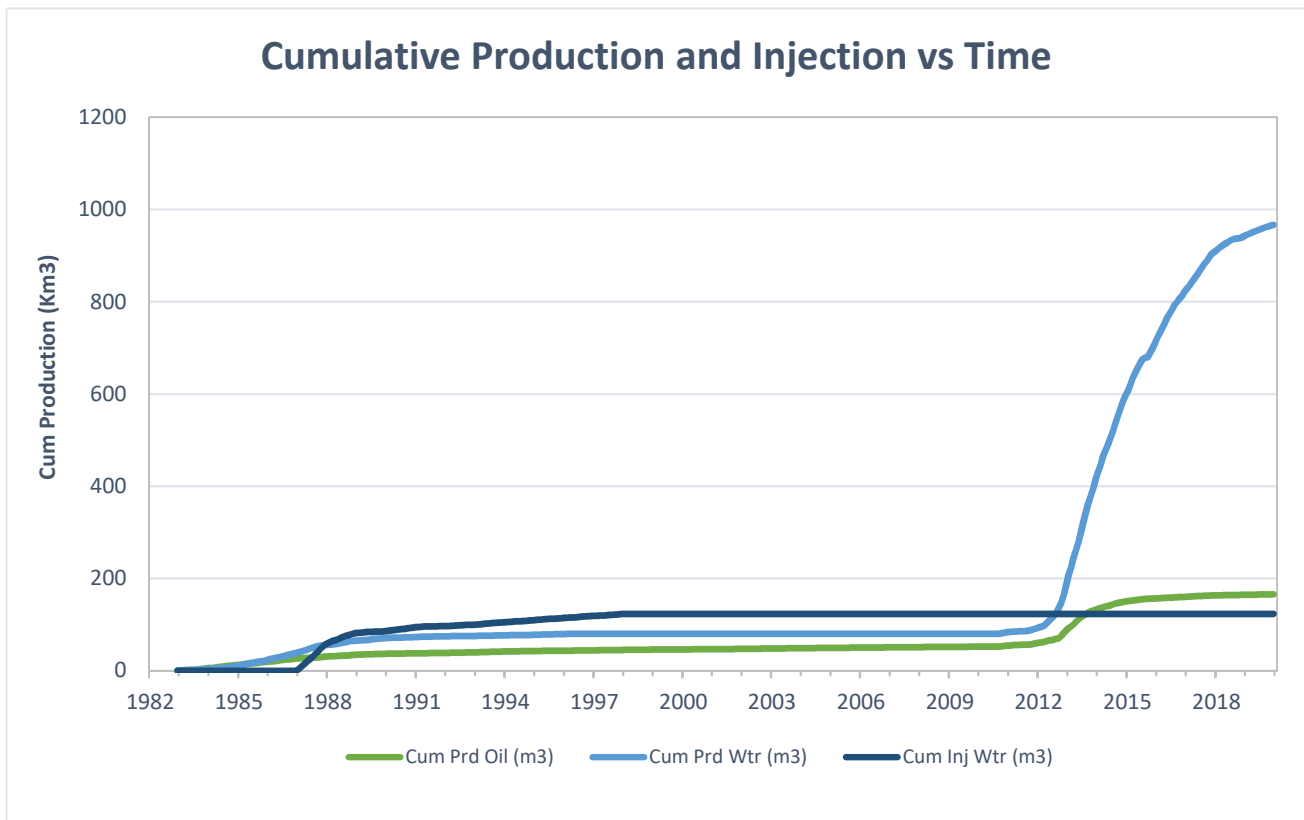

c) Well List

Waskada Unit No. 7 Well List

<i>UWI</i>	<i>Type</i>	<i>Status</i>	<i>Future Plans</i>
100/11-17-001-25W1/0	Vertical	Abandoned	-
102/11-17-001-25W1/0	Horizontal	Suspended	-
103/11-17-001-25W1/0	Horizontal	Producing	-
100/12-17-001-25W1/0	Vertical	Abandoned	-
100/13-17-001-25W1/0	Vertical	Abandoned	-
100/14-17-001-25W1/0	Vertical	Abandoned	-
102/14-17-001-25W1/0	Horizontal	Producing	-
103/14-17-001-25W1/0	Horizontal	Producing	-
104/14-17-001-25W1/0	Horizontal	Producing	-
100/01-18-001-25W1/0	Vertical	Abandoned	-
102/01-18-001-25W1/0	Horizontal	Producing	-
103/01-18-001-25W1/0	Horizontal	Suspended	-
104/01-18-001-25W1/0	Horizontal	Suspended	-
100/02-18-001-25W1/0	Vertical	Abandoned	-
100/07-18-001-25W1/2	Vertical	Abandoned	-
100/08-18-001-25W1/0	Vertical	Abandoned	-
100/09-18-001-25W1/0	Vertical	Abandoned	-
102/09-18-001-25W1/0	Horizontal	Suspended	-
100/16-18-001-25W1/0	Vertical	Abandoned	-
100/08-19-001-25W1/2	Vertical	Abandoned	-
100/03-20-001-25W1/0	Vertical	Abandoned	-
102/03-20-001-25W1/0	Horizontal	Suspended	-
103/03-20-001-25W1/0	Horizontal	Producing	-
104/03-20-001-25W1/0	Horizontal	Suspended	-
105/03-20-001-25W1/0	Horizontal	Producing	-
100/05-20-001-25W1/0	Vertical	Abandoned	-
102/05-20-001-25W1/0	Horizontal	Producing	-
103/05-20-001-25W1/0	Horizontal	Producing	-
100/06-20-001-25W1/0	Vertical	Abandoned Zone	-
100/11-20-001-25W1/0	Vertical	Producing	-
104/12-20-001-25W1/0	Horizontal	Producing	-
100/13-20-001-25W1/2	Vertical	Abandoned	-
102/13-20-001-25W1/0	Horizontal	Producing	-
103/13-20-001-25W1/0	Horizontal	Producing	-
100/14-20-001-25W1/0	Vertical	Abandoned Zone	-
100/15-20-001-25W1/0	Vertical	Abandoned	-
100/16-20-001-25W1/0	Vertical	Abandoned	-
102/16-20-001-25W1/0	Horizontal	Producing	-
103/16-20-001-25W1/0	Horizontal	Producing	-