

H U

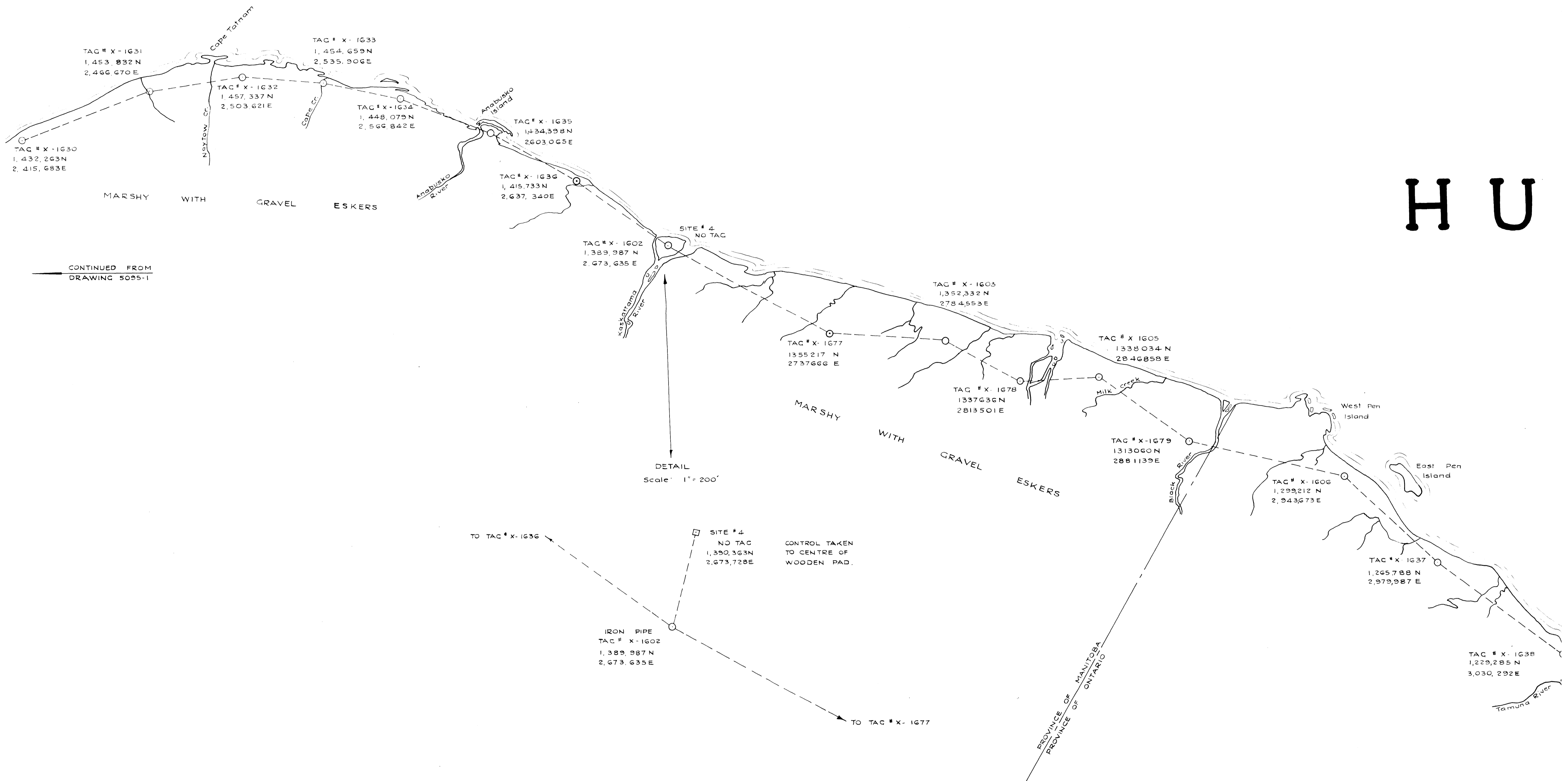

HUDSON BAY

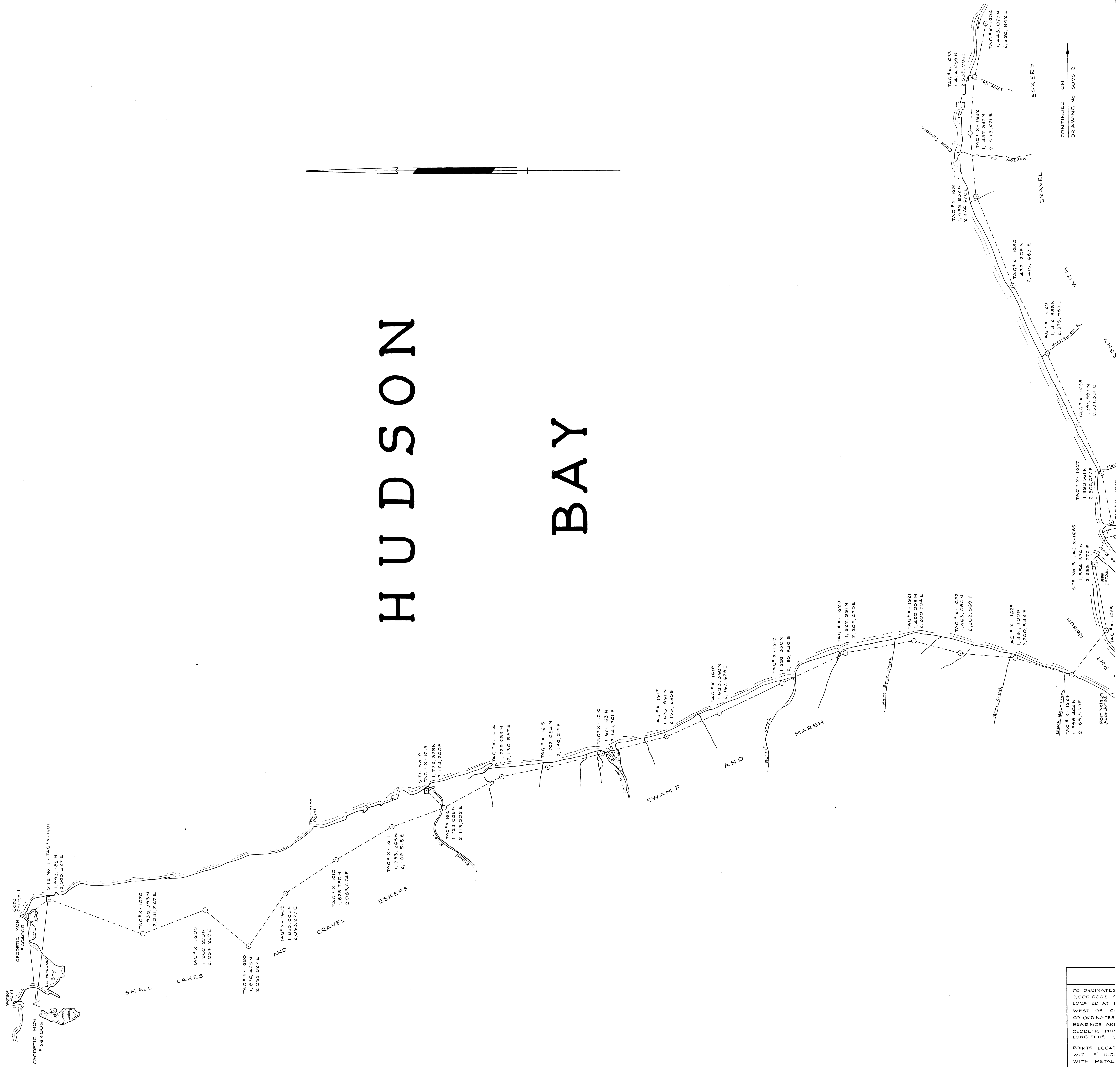

CO ORDINATES
 2,000,000E A
 LOCATED AT 1
 WEST OF C
 CO ORDINATES
 BEARINGS ARE
 GEODETIC MON
 LONGITUDE 1

POINTS LOCAT
 WITH 5 HIGH
 WITH METAL
 STATION DES
 NO. 5095-1

○ INDICATE
 □ INDICATE
 △ INDICATE
 RELIEF INF

CONTINUED ON
 DRAWING NO 5095-2

HUDSON

BAY

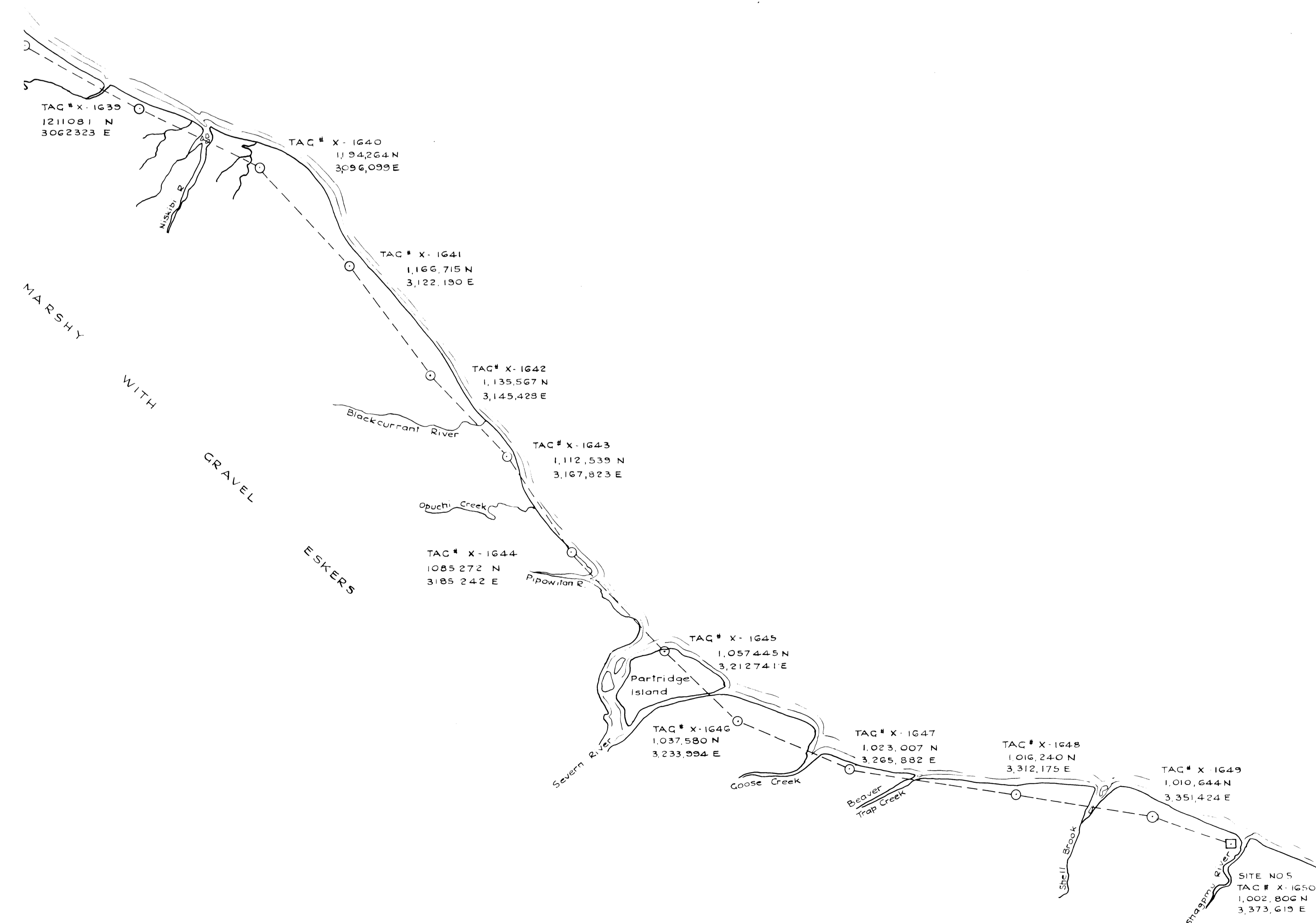

LEGEND			
<p>COORDINATES ARE ASSUMED 2 000 000 N AND 2 000 000 E AT GEODETIC MONUMENT # 664 005, LOCATED AT NORTON LAKE, COORDINATES ARE TO NEAREST FOOT. BEARINGS ARE ASTRONOMIC AND REFERRED TO GEODETIC MONUMENT # 664 005. LONGITUDE 93° 31' 08" LATITUDE 58° 45' 08"</p> <p>POINTS LOCATED ARE IRON BARS OR IRON PIPES WITH 5' HIGH WOODEN TRIPODS AND NUMBERED WITH METAL TACS.</p> <p>POINT NO X 1639 & POINT NO X 1643 ARE LOCATED WITH 2' X 2' WOODEN HUB. FOR STATION DESCRIPTION SEE DRAWING 5095-3.</p> <p>○ INDICATES TRAVERSE POINT</p> <p>□ INDICATES DECCA SITE LOCATION</p> <p>RELIEF INFORMATION IS ONLY APPROXIMATE</p>			
AQUITAINE CO. OF CANADA LTD.			
HUDSON BAY CONTROL SURVEY			
CANADIAN AIRBORNE CONTROL SURVEYS LTD.			
DRAWN BY	N.A. & D.Z.	JUNE 21, 1967	SCALE 1 INCH TO 1000 FEET
CHECKED BY	R.M.R.	FILE 5095	DRAWING NO. 5095-2

HUDSON BAY



LEGEND	
CO ORDINATES ARE ASSUMED 2,000,000N AND 2,000,000E AT GEODETIC MONUMENT #664005, LOCATED AT NORTON LAKE, APPROX 15 MILES WEST OF CAPE CHURCHILL, MANITOBA.	
CO ORDINATES GIVEN TO NEAREST FOOT	
BEARINGS ARE ASTRONOMIC AND REFERRED TO GEODETIC MONUMENT #664005	
LONGITUDE 93° 31' 08" LATITUDE 58° 45' 08"	
POINTS LOCATED ARE IRON BARS OR IRON PIPES WITH 5' HIGH WOODEN TRIPODS AND NUMBERED WITH METAL TAGS	
STATION DESCRIPTIONS ARE ON DRAWING NO. 5095-3	
○	INDICATES TRAVERSE POINT
□	INDICATES DECCA SITE LOCATION
△	INDICATES GEODETIC MONUMENT
RELIEF INFORMATION IS APPROXIMATE ONLY.	

AQUITAINE CO. OF CANADA LTD.			
HUDSON BAY CONTROL SURVEY			
CANADIAN AIRBORNE CONTROL SURVEYS LTD.			
DRAWN BY:	R M R	JUNE 21, 1967	SCALE: 1 INCH = 20,000 FEET
CHECKED BY:	D C Z.	FILE 5095	DRAWING NO: 5095-1

CONTINUED ON
DRAWING NO 5095-2

DETAIL
SCALE: 1 IN. = 2000 FT.
SITE'S TAG # 1625
TAG X-1625
1,378,354 N
2,219,745 E

EXISTING TOWER
AT
MARSH POINT
1,360,637 N
2,252,821 E